

1. MECHANICAL & ASSEMBLY :

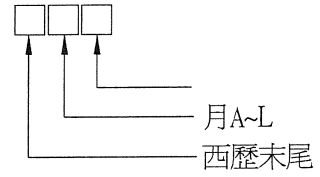

CORE TAPE 3Ts

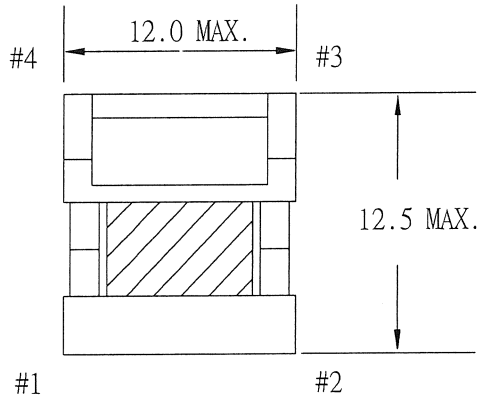
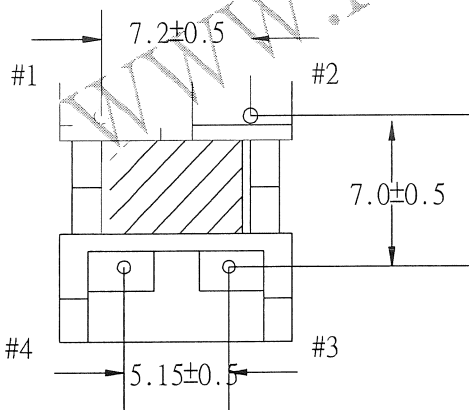
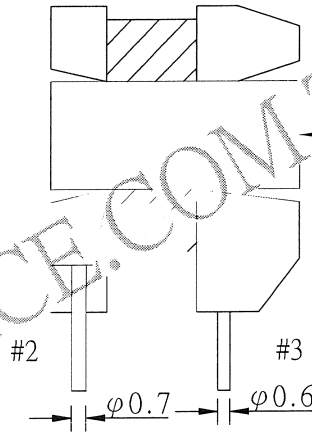
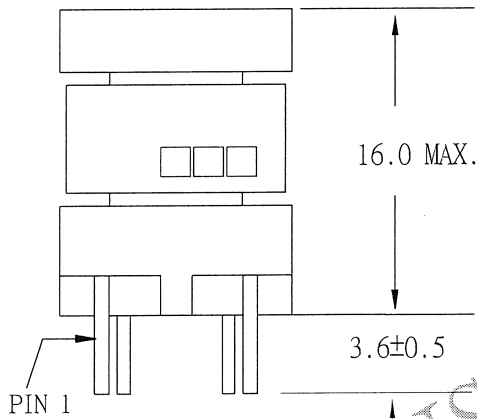

NOTE:

1. EPOXY FIXED TOP OF BOBBIN & CORE.(ONE POINT AT PIN 1-2 SIDE).
- 2.A DHESIVE EP-138 FIXED BETWEEN CORE & CORE (TTL:2 POINTS).

UNIT:mm

REPORT BY	CHECK BY	APPROVED BY	CUSTOMER :	DATE	
			PART NO : 54P-16039	REV NO.	
			ISSUE NO :	PAGE	4 - 1

2. WINDING CONFIGURATION:

STEP	WINDING	MARGIN TAPE	START-FINISH	COPPER WIRE	TURNS	LAYER TAPE	METHOD
1	P1		4 - 3	0.60φ	1		
2	S1		1 - 2	0.16φ	100	2Ts	CLOSE

NOTE:

3. ELECTRICAL CHARACTERISTICS:

PIN NO.	INDUCTANCE 1KHz, 0.1Vrms	LEAKAGE INDUCTANCE KHz, Vrms	VOLTAGE RATIO(V) F= 20KHz INPUT 1Vrms	DCR MAX. AT 25°C
1 - 2	6.0mH MIN			2.7 Ω
4 - 3			0.0100Vrms±5.0%	2.7mΩ

HI-POT TEST :(AT 1 mA , 2SEC.)

PRI TO SEC 2400 VAC

INSULATION RESISTANCE:(AT DC 500V)

PRI TO SEC 100 MΩ MIN.

REPORT BY	CHECK BY	APPROVED BY	CUSTOMER :	DATE
			PART NO : 54P-16039	REV NO.
			ISSUE NO :	PAGE 4 - 2

PRISOURCE ELECTRONICS CO.,LTD.

4. WINDING SEQUENCE:

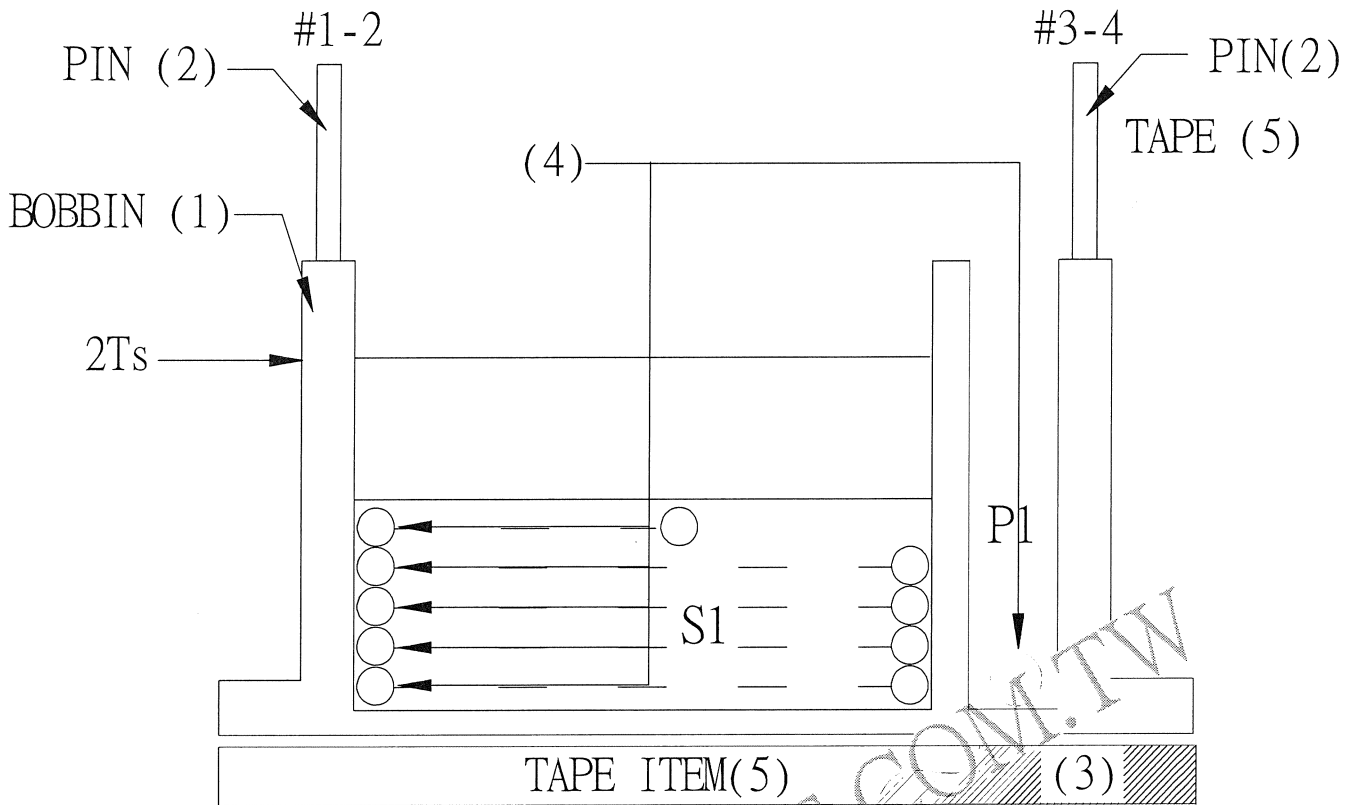

P1 WINDING FROM PIN3~4 SIDE
 S1 WINDING FROM PIN1~2 SIDE

5. SCHEMATIC:

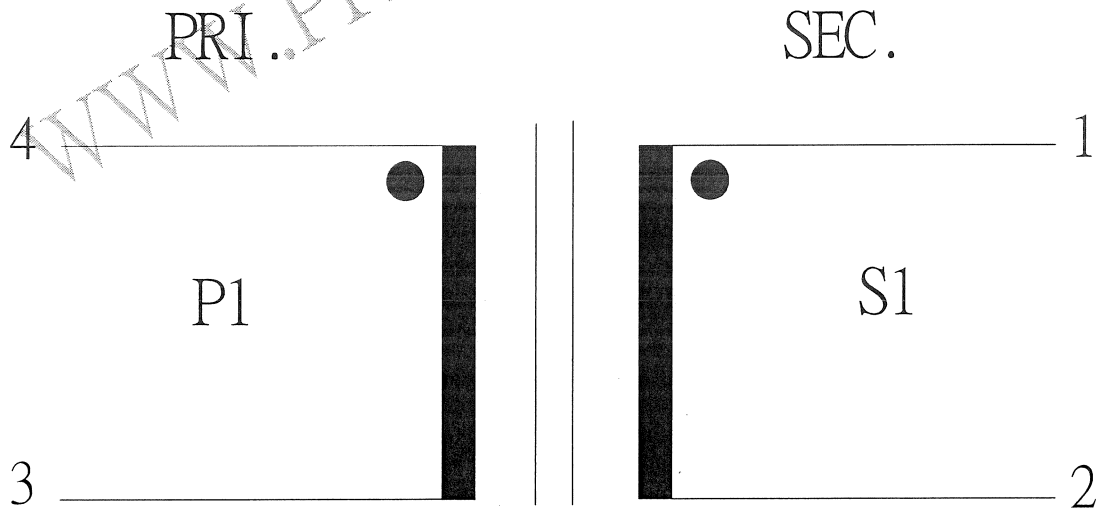

REPORT BY	CHECK BY	APPROVED BY	CUSTOMER :	DATE	
			PART NO : 54P-16039	REV NO.	
			ISSUE NO :	PAGE	4 - 3