

1. MECHANICAL & ASSEMBLY :

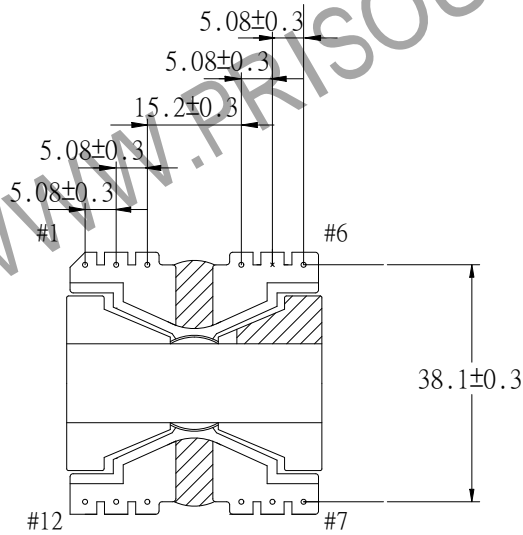
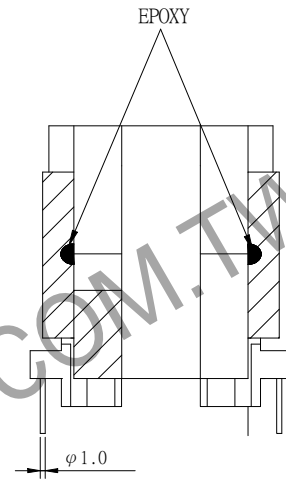
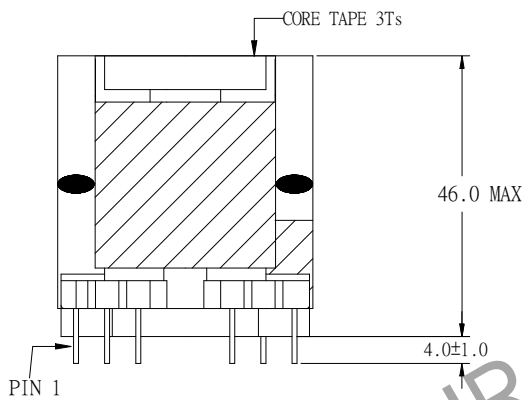
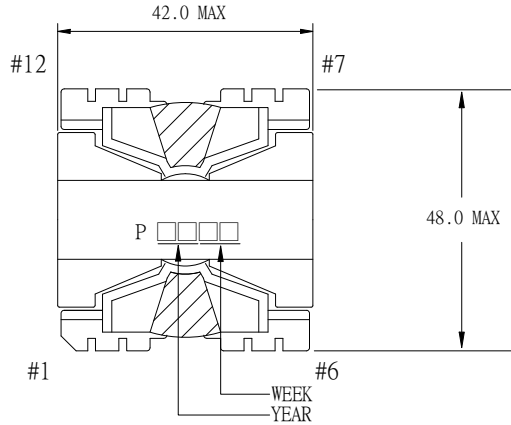

NOTE:

1. EPOXY FIXED BETWEEN CORE & CORE (TTL:4 POINTS)EPOXY FIXED TOP OF BOBBIN & CORE.(ONE POINT).
2. ADHESIVE EP-106 FIXED BETWEEN CORE & CORE (TTL:2 POINTS)
3. PIN 5 NO.

UNIT:m/m

REPORT BY	CHECK BY	APPROVED BY	CUSTOMER :	DATE	
			PART NO : 54P-12017	REV NO.	
			ISSUE NO :	PAGE	4 - 1

2. WINDING CONFIGURATION :

STEP	WINDING	MARGIN TAPE	START-FINISH	COPPER WIRE	TURNS	LAYER TAPE	TUBE	METHOD
1	A		7 - 8	0.35 ϕ ×14	12	12Ts	2.5 ϕ	CLOSE
2	P		6 - 4	TEX-E 0.35 ϕ ×12	16	12Ts	2.5 ϕ	CLOSE
3	B		8 - 9	0.35 ϕ ×14	12	1T	2.5 ϕ	CLOSE
4	C	1.5mm/1.5mm×1T	11 - 12	0.30 ϕ	4	2Ts	0.8 ϕ	SPACE
5	反折		8 -			1T	3.5 ϕ	

NOTE:

3. ELECTRICAL CHARACTERISTICS :

PIN NO.	INDUCTANCE 1 KHz, 1.0Vrms	LEAKAGE INDUCTANCE KHz, Vrms	VOLTAGE RATIO(V) F= 20KHz INPUT 1Vrms	DCR MAX. AT 25°C
6 - 4	200.0uH±10%			26.0 m Ω
7 - 8			0.7417Vrms±3.0%	14.0 m Ω
8 - 9			0.7510Vrms±3.0%	22.0 m Ω
11 - 12			0.2501Vrms±4.0%	155.0 m Ω

HI-POT TEST : (AT 1 mA , 2SEC.)

PRI. TO SEC. 3600. VAC

INSULATION RESISTANCE:(AT DC 500V)

PRI. TO SEC. 100 M Ω MIN.

REPORT BY	CHECK BY	APPROVED BY	CUSTOMER :	DATE
			PART NO : 54P-12017	REV NO.
			ISSUE NO :	PAGE 4 - 2

4. WINDING SEQUENCE:

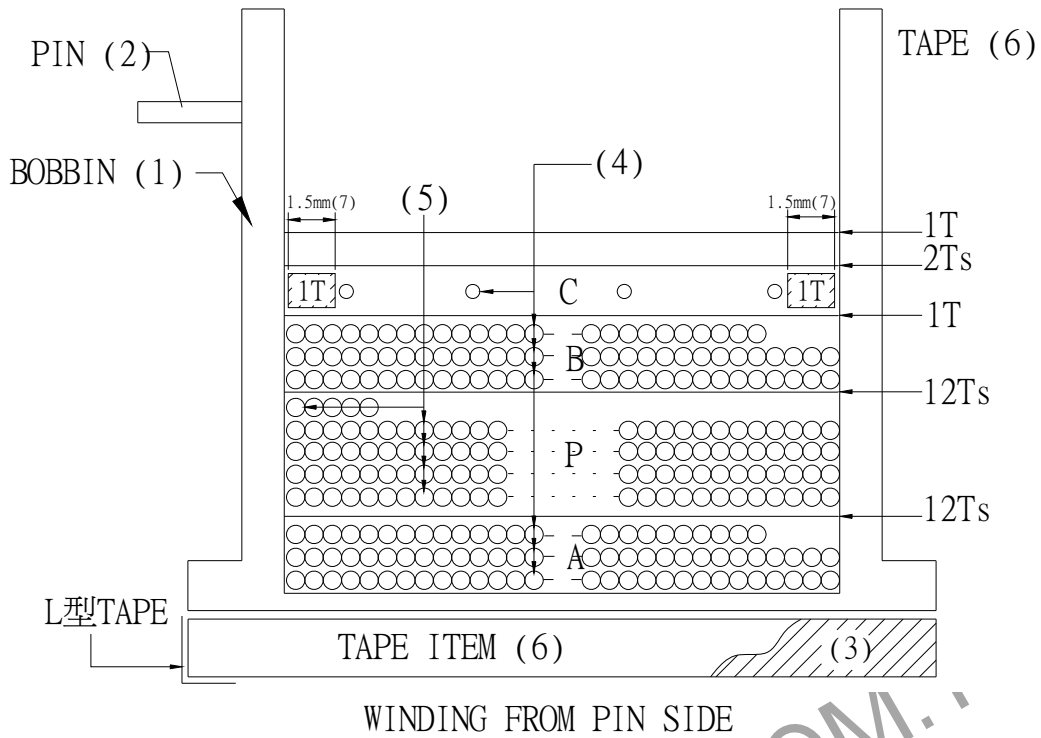

5. SCHEMATIC:

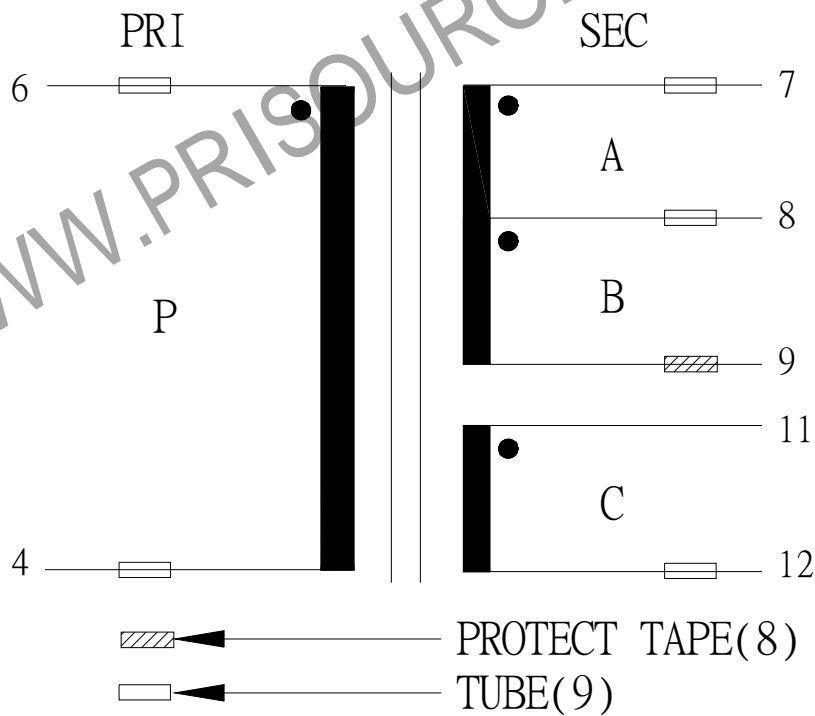

REPORT BY	CHECK BY	APPROVED BY	CUSTOMER :	DATE	
			PART NO : 54P-12017	REV NO.	
			ISSUE NO :	PAGE	4 - 3

6. MATERIAL LIST :

NO.	DESCRIPTION	ITEM	MATERIAL	LIST OF SAMPLE	UL NO.	MANUFACTURER
1	BOBBIN	(1)	PHENOLIC (T375HF) Thickness:0.50mm Min.	✓	E59481	CHANG CHUN
2	PIN	(2)	TINNED COPPER WIRE Φ1.0	✓		WELL FORE
3	CORE	(3)	FERRITE CORE PQ4040 TP4 CORE GAP : 0.27mm	✓		TDG
4	COPPER WIRE	(4)	POLYURETHANE(2UEW) TYPU-130 MW75-C	✓	E197768	HENG YA
5	TRIPLE WIRE	(5)	TEX-E	✓	E206440	FURUKAWA
6	MYLAR TAPE	(6)	POLYESTER FILM #1318-1 (Y) Thickness: 0.06mm #1318-2 (Y) Thickness: 0.08mm	✓	E17385	3M
7	MARGIN TAPE	(7)	COMPOSITE FILM #44T-A	✓	E17385	3M
8	ROTECT TAPE	(8)	COMPOSITE FILM #44-A Thickness: 0.14mm	✓	E17385	3M
9	TUBE	(9)	SILICON TUBE RSU-1 Thickness: 0.40mm	✓	E67922	NISSEI
10	EPOXY		6020H EP-106	✓ ✓	E229633	WELLS CEMEDINE
11	VARNISH		WP-2952F-2G	✓	E72979	HITACHI

REPORT BY	CHECK BY	APPROVED BY	CUSTOMER :	DATE
			PART NO : 54P-12017	REV NO.
			ISSUE NO :	PAGE
				4 - 4